

GALAXY INTERNATIONAL CONVENTION CENTER

ASIA'S MOST ICONIC AND
ADVANCED MICE DESTINATION



GALAXY™
INTERNATIONAL
CONVENTION CENTER
銀河國際會議中心

GALAXY INTERNATIONAL CONVENTION CENTER



A NEW CHAPTER IN INTEGRATED RESORT DEVELOPMENT

Galaxy International Convention Center (GICC) is the latest addition to Galaxy Entertainment Group's ever expanding integrated resort precinct and will usher in a new era for the MICE industry in Macau.

GICC — Asia's most iconic and advanced MICE destination — is a world class event venue featuring 40,000 sqm of total flexible MICE space that can cater for up to 8,500 banquet guests, or cocktail parties for as many as 12,000 guests. The 10,000 sqm pillar less exhibition hall located on the ground floor, can accommodate up to 7,000 delegates. The exhibition hall is also perfectly suited for banquets of approximately 6,500 guests or cocktail parties for 8,500 guests.

Conveniently set within GICC, the 16,000-seat Galaxy Arena is the largest indoor arena in Macau and where spectacular events come to life — from world concert tours to thrilling fight nights. Our arena offers center-stage, end-stage or boxing ring set-ups, all of which are customizable for your event.

Andaz Macau, a vibrant lifestyle hotel rooted in local art and culture, is seamlessly connected to GICC and offers immersive experiences that are specifically tailored for both business and leisure travellers. Featuring more than 700 uniquely appointed rooms and suites, Andaz Macau is also home to an exciting selection of culinary options.

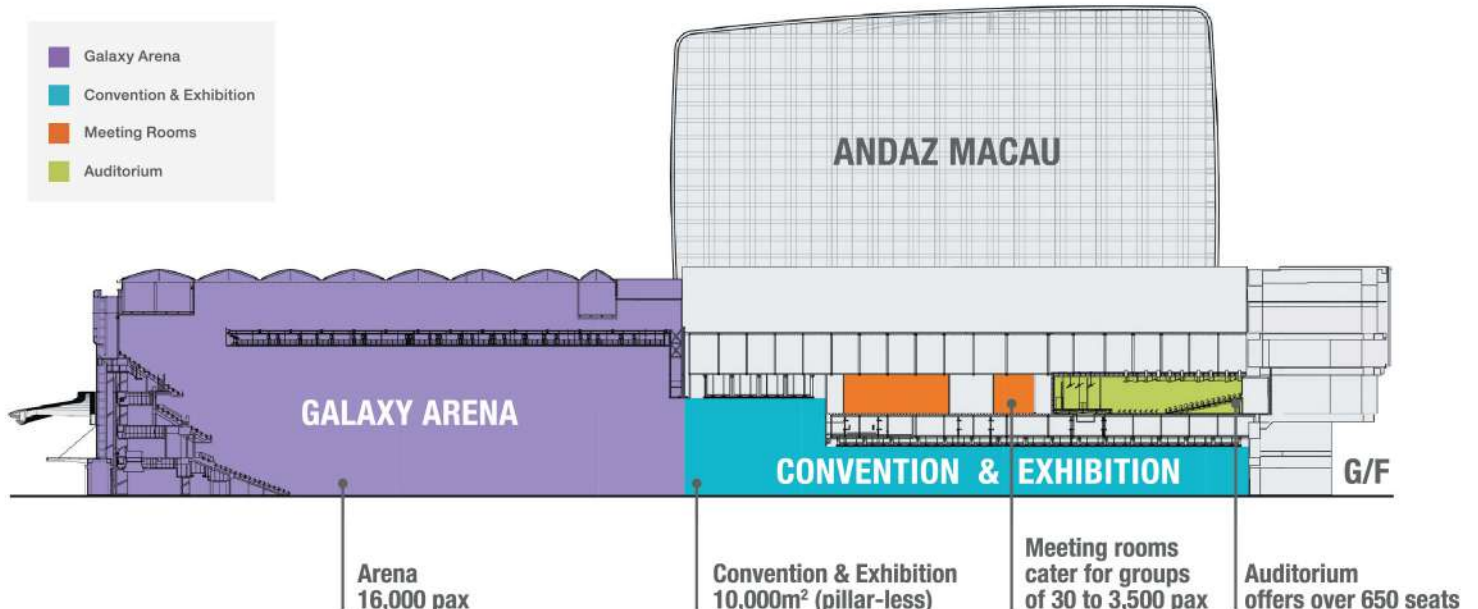

01 CONFERENCE

TRANSPORT YOUR GUESTS TO WHOLE NEW WORLDS

The ground level space offers nearly 4,000m² in conference mode with 9m ceiling height. It consists of 3 partitionable spaces which can be separated into 3 convention spaces. Each area is fitted with built-in infrastructure for audio-visual timeline. The space is also equipped with the most advanced programmable LED ceiling which offers different ambience for any genre of events.

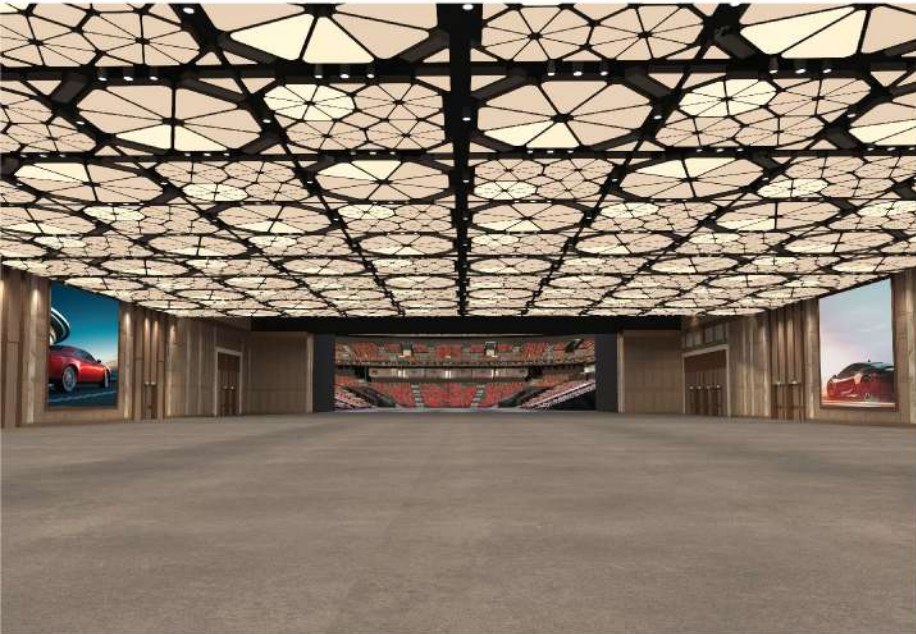
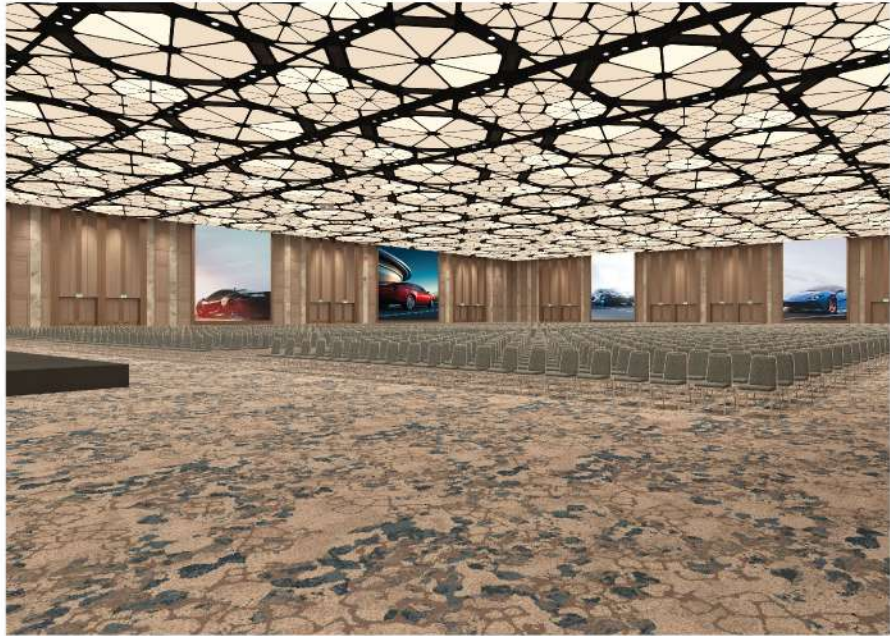

02 EXHIBITION

FULLY FLEXIBLE FOR EVENTS OF ANY SCALE

There is 10,000m² of pillar-less space to accommodate up to 7,000 delegates and GICC is the perfect venue for a wide range of exhibitions. The space can be divided into multiple separate halls with highly soundproof partitions for smaller scale events. Set-up and logistics are also made simple and efficient with direct vehicle access for loading and unloading, easy access rigging grids, complete utility services (water, power and communications) via floor trenches and full catering support for each hall.

03 BANQUET

THE FINEST CULINARY AND SERVICE STANDARDS

From exclusive corporate dinners to gala banquets for up to 2,600 guests, everyone will be assured of the very best in service and culinary craftsmanship. GICC offers a diverse range of cuisines by world recognized chefs for both large banquets and smaller events. Guests will be in awe of the immersive high-definition digital screens that can transport them to any time or place for that very unique occasion.



04 GALAXY ARENA

THE PREMIER SPACE FOR WORLD-CLASS EVENTS

The 16,000-seat Galaxy Arena is the largest indoor arena in Macau and where spectacular events come to life — from world concert tours to thrilling fight nights. Our arena offers center-stage, end-stage or boxing ring set-ups, all of which are customizable for your event. With unobstructed views and high-definition broadcasting enabled by advanced technical infrastructure, every guest will enjoy amazing 360° views and high quality surround sound. The arena also features 8 Hospitality Suites for guests to relax and network in luxuriously private surrounds.



05 BALLROOM AND MEETING ROOMS

PERFECT SPACES FOR ANY OCCASION

In addition to its large function venues, GICC has flexible combinations and generous networking spaces for hosting the world's most discerning corporate clients and conference delegates. 33 meeting rooms, capable of hosting over 3,500 guests is perfect for any special occasion. All meeting rooms have built-in state-of-the-art audio-visual technology, data channels and broadcast communications, providing everything you and your distinguished guests may require.



06 AUDITORIUM

A VERSATILE AND INTIMATE VENUE

Built to world-class standard, this 650-seat Auditorium is equipped with state-of-the-art audio-visual, sound and lighting systems and presentation system. Logistically, it has a fully motorized rigging system, easy access to service elevators and a fixed stage with floor loading of 5kN/m², designed to the world's highest performance standards. An excellent choice for keynote sessions, opening ceremonies, cultural and musical performances, and new product launches of the region.



FLOOR PLANS

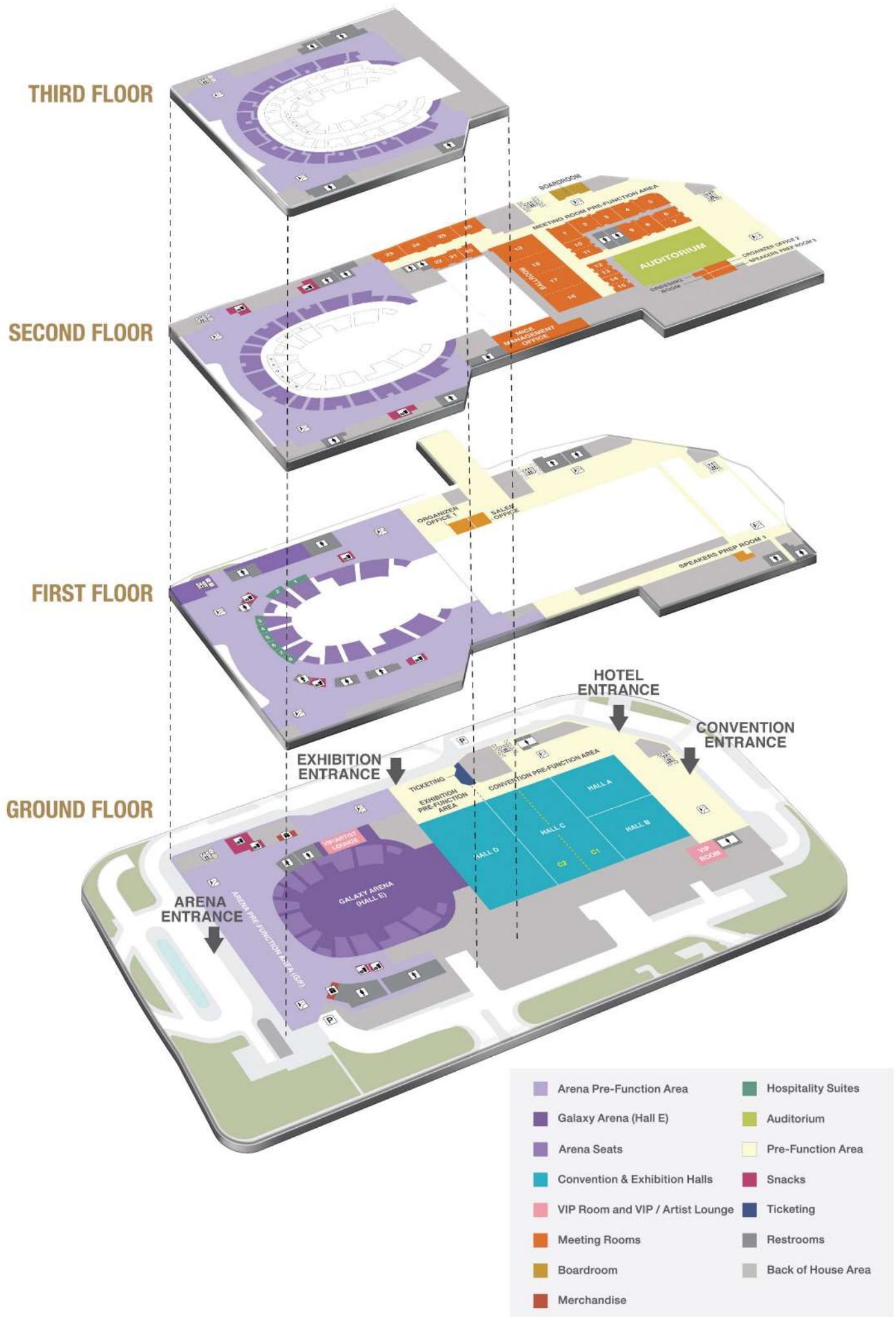

GROUND FLOOR



FULL EXHIBITION AREA

Approximately **10,000m²** of pillar-less exhibition area, suitable for hosting large-scale international exhibitions. Flexible layout to suit different exhibition themes. and **533 exhibition booths** (3m x 3m).



EXTENDED ARENA + 1 HALL

The space can be split into **2 zones**:
An extended arena (in boxing mode when extended into exhibition hall); a large convention / exhibition / banquet area.
Extended arena: **16,000 pax**.



ARENA + 1 HALL

The space can be split into **2 zones**:
An arena; a large convention / exhibition / banquet area.
Arena: **12,000 pax**.



ARENA + 2 HALLS

The space can be split into **3 zones**:
An arena; 2 exhibition halls.
Activities can be held in all 3 zones simultaneously.

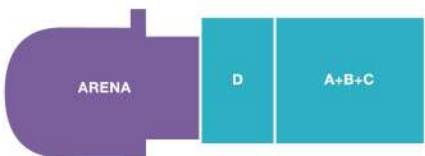

ARENA + 2 HALLS

The space can be split into **3 zones**:
An arena; a large banquet area (with **200 tables**); an exhibition hall.
Activities can be held in all 3 zones simultaneously.

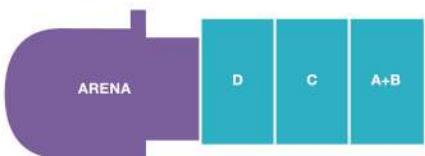

ARENA + 3 HALLS

The space can be split into **4 zones**:
An arena and 3 separate halls; hosting a performance, convention, exhibition, and banquet concurrently.

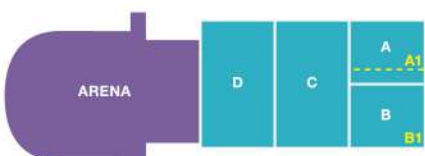

ARENA + 4 HALLS

The space can be split into **5 zones**:
An arena and 4 separate halls; hosting a performance, convention, exhibition, banquet, and meeting all at the same time.

SECOND FLOOR



MEETING ROOMS

Select from meeting rooms of different sizes (that can cater for more than 3,500 guests), perfect for breakout sessions.

AUDITORIUM

Area: 1,036m²
Capacity: 652 seats (theater set-up)

KEY FEATURES



PARKING

- Dedicated parking spaces for designated guests
- Additional 1,080 spaces available across the resort



TRUCK ACCESS

2 direct access points to hall and arena floor area with 10 loading docks at basement



ELEVATORS

- 14 passenger elevators
- 4 freight elevators with 4,500kg capacity
- 10 service elevators that provide between 800 and 2,000kg capacity
- 1 car elevator with 7,200kg capacity
- 29 escalators



CLEARANCE

- Halls A, B & C: 9m to the bottom of truss
- Hall D: 20m to bottom of truss
- Hall E: 28m to bottom of truss
- Meeting room: 4-6m to ceiling



TELECOMMUNICATIONS

- Optimum connectivity with extended bandwidth, low latency and zero package loss enabled by the latest Wi-Fi 6 technology, plus a 5G wireless network to ensure seamless, high-speed data transmission
- Guests can expect high quality, real-time VR and AR experiences, video streaming and live voting as well as the smooth facilitation of automatic guided machine operations and robotics



PRE-FUNCTION

More than 6,000m² of pre-function space



ELECTRICAL

- Supply voltage at 230V (single-phase) / 400V (three-phase); 50Hz
- Arena
 - Total 1,800A @ 400V power available at floor level for production
 - Total 400A @ 400V power available at grid level for rigging and production lights
- Convention & Exhibition
 - Total 1,600A @ 400V power available at floor level for production



FOOD & BEVERAGE SERVICES

- 11 snacks kiosks in arena
- 1 production kitchen + 2 satellite kitchens
- Mobile kiosks
- 2 restaurants



AUDIO-VISUAL

Comprehensive A/V production support



BUSINESS SERVICES

Provide on-site business services: faxing, copying, express mail, packaging, printing, etc.



CUSTOMER SERVICES

- ATM
- Concierge, restaurant information and reservations



DIGITAL DISPLAY

Market your events across a number of digital displays and wayfinders at eye-catching locations on the GICC exterior and indoors, to attract the attention of meeting delegates, event visitors and passersby



CREATE IMPACTFUL EVENTS WITH EVENT STUDIO

We believe in the power of co-creation. Our in-house EVENT STUDIO team at Galaxy Macau™ is an experienced group of creative planners who will partner with you to design events that make an impact. EVENT STUDIO provides expertise that goes beyond conventional event planning by assisting with venue selection, conceptualizing themes, décor, entertainment, visual and lighting effects as well as marketing coordination. We will attend to every detail, so that you can experience a bespoke and seamlessly executed event. Our events planning team will also be with you from day one to ensure that your event is well-organized and runs smoothly.

SEATING CAPACITY

Floor	Room	Area (m ²)	Theater [†]		Classroom [†]		Cocktail [‡]		Banquet [‡]		U-shape		Boardroom		Hollow Space		Exhibition (3x3)m ²	
			Capacity	Capacity	Capacity	Capacity	Capacity	Capacity	Capacity	Capacity	Capacity	Capacity	Capacity	Capacity	Capacity	Capacity	Capacity	Capacity
Ground Floor	Hall A	723	636		412		687		504		-	-	-	-	-	-	-	43
	Hall B	725	638		413		689		504		-	-	-	-	-	-	-	44
	Hall C	1,930	1,698		1,100		1,834		1,344		-	-	-	-	-	-	-	116
	Hall D (Expo)	1,600	1,408		912		1,520		1,116		-	-	-	-	-	-	-	96
	Hall E (Arena)	3,250	2,860		1,853		3,088		2,268		-	-	-	-	-	-	-	195
	A+B	1,488	1,274		825		1,376		1,008		-	-	-	-	-	-	-	87
	A+B+C	3,713	3,572		2,100		3,527		2,592		-	-	-	-	-	-	-	223
	A+B+C+D	5,638	4,961		3,214		5,356		3,936		-	-	-	-	-	-	-	338
	A+B+C1	2,597	2,285		1,480		2,467		1,812		-	-	-	-	-	-	-	156
	C2+D	2,740	2,411		1,562		2,603		1,920		-	-	-	-	-	-	-	164
	A+B+C+D+E	8,888	7,821		5,066		8,444		6,216		-	-	-	-	-	-	-	533
	VIP Room	65	-	-	-	-	-	-	-	-	20	-	-	-	-	-	-	-
	Convention Pre-function Area	2,164	-	-	-	-	-	1,900	-	-	-	-	-	-	-	-	-	-
	Exhibition Pre-function Area	617	-	-	-	-	-	550	-	-	-	-	-	-	-	-	-	-
	Total Pre-function Area	2,781	-	-	-	-	-	2,450	-	-	-	-	-	-	-	-	-	-
Speakers Preparation Room 1	38	-	-	-	-	-	-	-	-	-	-	-	-	-	-	-	-	
Organizer Office 1	57	-	-	-	-	-	-	-	-	-	-	-	-	-	-	-	-	
Second Floor	Meeting Room 1	122	112		72		115		72		24		48		36		-	
	Meeting Room 2	104	199	106	176	67	114	102	190	72	132	21	40	43	80	32	60	-
	Meeting Room 3	95	190	92	176	60	114	92	190	60	132	19	40	39	80	29	60	-
	Meeting Room 4	102	190	104	194	64	126	99	210	72	144	21	44	42	88	31	66	-
	Meeting Room 5	88	190	96	194	67	126	109	210	72	144	23	44	46	88	35	66	-
	Meeting Room 6	67	142	67	121	38	78	63	130	36	84	13	27	26	55	20	41	-
	Meeting Room 7	75	142	67	121	44	78	71	130	48	84	15	27	30	55	23	41	-
	Meeting Room 8	93	190	96	171	63	111	88	184	72	144	19	39	37	78	28	58	-
	Meeting Room 9	97	190	96	171	63	111	92	184	72	144	19	39	39	78	29	58	-
	Meeting Room 10	66	131	73	120	52	78	64	129	48	96	13	27	27	54	20	41	-
	Meeting Room 11	65	131	73	120	52	78	64	129	48	96	13	27	27	54	20	41	-
	Meeting Room 12	41	82	40	74	27	48	40	80	24	48	8	17	17	34	13	25	-
	Meeting Room 13	41	82	40	74	27	48	40	80	24	48	8	17	17	34	13	25	-
	Meeting Room 14	41	82	40	74	27	48	40	80	24	48	8	17	17	34	13	25	-
	Meeting Room 15	41	82	40	74	27	48	40	80	24	48	8	17	17	34	13	25	-
	Meeting Room 16	268	539	298	482	180	312	261	521	168	384	55	110	110	219	83	164	-
	Meeting Room 17	271	539	300	482	180	312	261	521	168	384	55	110	110	219	83	164	-
	16+17 with 200m ² corridor	739	-	661	-	428	-	713	-	540	-	150	-	300	-	225	-	-
	Meeting Room 18	233	463	244	462	140	299	224	499	168	324	47	105	94	210	71	158	-
	Meeting Room 19	230	463	242	462	140	299	224	499	168	324	47	105	94	210	71	158	-
	18+19 with 170m ² corridor	633	-	568	-	368	-	614	-	468	-	129	-	258	-	194	-	-
	16+17+18+19 with 370m ² corridor	1,372	-	1,229	-	796	-	1,327	-	1,008	-	279	-	559	-	419	-	-
	Meeting Room 20	60	-	68	-	32	-	60	-	48	-	13	-	25	-	19	-	-
	Meeting Room 21	69	139	76	121	36	79	66	131	48	96	14	28	28	55	21	41	-
	Meeting Room 22	70	139	76	121	36	79	65	131	48	96	14	28	27	55	20	41	-
	Meeting Room 23	101	-	114	-	69	-	101	-	72	-	21	-	42	-	32	-	-
	Meeting Room 24	110	207	124	188	69	122	107	203	72	144	23	43	45	86	34	64	-
	Meeting Room 25	97	207	124	188	69	122	107	203	72	144	23	43	45	86	34	64	-
	Meeting Room 26	108	-	124	-	69	-	104	-	72	-	22	-	44	-	33	-	-
	Meeting Room 1-26	2,755	-	-	-	-	-	2,737	-	-	-	-	-	-	-	-	-	-
	Boardroom	92	-	112	-	80	-	97	-	72	-	20	-	41	-	31	-	-
	Boardroom Lounge	96	-	60	-	40	-	65	-	48	-	14	-	27	-	20	-	-
Organizer Office 2	29	-	-	-	-	-	-	-	-	-	-	-	-	-	-	-	-	
Speakers Preparation Room 2	37	-	-	-	-	-	-	-	-	-	-	-	-	-	-	-	-	
Auditorium	1,036	-	652	-	-	-	-	-	-	-	-	-	-	-	-	-	-	
Meeting Room Pre-function Area	2,637	-	-	-	-	-	2,300	-	-	-	-	-	-	-	-	-	-	

Arena	Capacity
End Stage	12,500
Center Stage*	15,000
Boxing*	16,000
Sporting	12,600
Arena Pre-function Area (G/F)	3,898

* Extension to exhibition hall to reach maximum capacity
[†] With stage set up capacity
[‡] Without stage set up capacity

Galaxy International Convention Center

Galaxy Macau™, COTAI, Macau
 Sales Hotline: +853 8883 1628 Fax: +853 8883 3988
 Email: sales@galaxyentertainment.com
 Website: galaxyicc.com



LinkedIn

e-newsletter

WeChat